



Winch & Ratchet Replacement Straps & Winch Bars



Beaver Truckers' Cargo Winch Polyester Replacement Straps
Complies to AS/NZS 4380-2001

Beaver Code	Description	Lashing Capacity
342305WF	50mm x 5m Gate Winch Replacement Strap c/w Double "J" Hook	2000kg
342305W	50mm x 9m Winch Replacement Strap	2500kg
342305W-11	50mm x 11m Winch Replacement Strap	2500kg
342313	50mm x 9m Winch Replacement Strap	3000kg
342313-12	50mm x 12m Winch Replacement Strap	3000kg
CWS075SD09H	75mm x 9m Strap c/w hook & Keeper S/Duty	3500kg
CWS075HD09H	75mm x 9m Strap c/w hook & Keeper H/Duty	5000kg



Beaver Truckers' Ratchet Tie-down (RTD) Polyester Replacement Straps
Complies to AS/NZS 4380-2001

Beaver Code	Description	Lashing Capacity
349302R	50mm x 9m RTD Replacement Strap c/w hook & Keeper	2500kg
349302R-11	50mm x 11m RTD Replacement Strap c/w hook & Keeper	2500kg
349302R-12	50mm x 12m RTD Replacement Strap c/w hook & Keeper	2500kg
349303R	50mm x 9m RTD Replacement Strap c/w hook & Keeper	3000kg
349303R-12	50mm x 12m RTD Replacement Strap c/w hook & Keeper	3000kg
349305R	75mm x 9m RTD Replacement Strap c/w hook & Keeper	5000kg
349305R-12	75mm x 12m RTD Replacement Strap c/w hook & Keeper	5000kg



Beaver Truckers' MK-VI Reversible Ratchet Winch Bar

Beaver Code	Description
342420	for use with MK VI winches only



Beaver Truckers' Winch Bar

c/w Safety trigger and knurled non-slip handle for easy grip (all steel construction and chrome plated) for use with all Mark IV winches.

Beaver Code	Description
343400S	winch bar chrome plated with safety retaining device

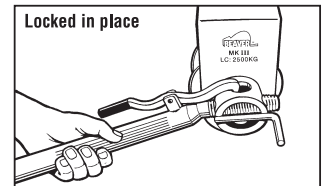
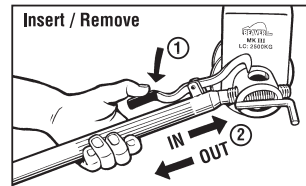

WARNING

- Never release the winch bar Safety Retaining Device without checking that the ratchet pawl is fully engaged between the ratchet gear teeth.
- Releasing a winch bar without the ratchet pawl being fully engaged can cause serious injury to the user or bystanders.

Safety and Operating Instructions

- "Cheater Bars"(extenders) should not be used with winch bars.
- To prevent the winch bar from slipping out and overloading the tip and / or end cap, the tip of the winch bar shall be inserted through both opposing slotted holes on the winch drum end cap of the Beaver Mark III Truck Winches.



Beaver Truckers' Winch Bar

c/w Rubber handle steel bar (chrome plated). For use with all Mark IV winches.

Beaver Code	Description
343400	winch bar chrome plated

Note:

Winch Bars shall not be used as Cheater Bars in any way whatsoever.

Corner Protectors, Rubber Tie Downs, Friction Mats & Tools



Beaver Corner Protector

Poly Propylene



Beaver Code	Description
340000	Corner Protector 140 x 140 x 1040mm
340010	Corner Protector 85 x 85 x 300mm

Beaver Friction Mats

Highly compressed rubber granular Re-cycled material



Beaver Code	Description
350000	Friction Mat - 1000 x 1000 x 8mm

Beaver's anti slippage friction mats increase the resistance between the body surface and the load being carried by the vehicle.

WARNING

Avoid eye injury. **DO NOT** over stretch. **ALWAYS** keep face and body out of recoil path. **DO NOT** use when strap has visible signs of wear or damage



Beaver EPM Rubber Tie Downs for tarps

c/w "S" Hooks at each end

Beaver Code	Strap Length inch.	Max. Safe Stretch inch.	Qty per bag
340721	21	32	10
340731	31	46	5

WARNING

- Rubber tarp ties lose strength with wear & age.
- They are not designed to hold a load in place.
- Over-tension can cause tie-down to snap, creating a potential risk of injury.
- Always wear safety glasses during tie-down & disconnect.
- Discard if cut, cracked or abraded.

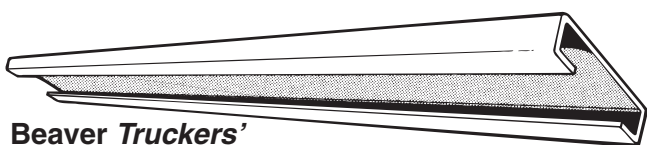

Beaver Truckers' Slide-on Winch Rail

Beaver Code	Description
342402	Slide-on winch rail - 2400mm

NOTE: Natural steel finish, ready for welding to trailer. Manufacturer's tolerances and radii apply.

Roval Jumbo Size Combination Ring Open End Spanner Sets

Suit trucking, mining, heavy engineering & earth moving equipment.



Beaver Code	Qty	Description
SJC004	4	AF 2 ¹ / ₈ " , 2 ¹ / ₄ " , 2 ³ / ₈ " , 2 ¹ / ₂ "
SJC006	6	AF 1 ³ / ₈ " , 1 ¹ / ₂ " , 1 ⁵ / ₈ " , 1 ³ / ₄ " , 1 ⁷ / ₈ " , 2"
SJC010	10	AF 1 ⁵ / ₁₆ " , 1 ³ / ₈ " , 1 ⁷ / ₁₆ " , 1 ¹ / ₂ " , 1 ⁵ / ₈ " , 1 ¹¹ / ₁₆ " , 1 ³ / ₄ " , 1 ¹³ / ₁₆ " , 1 ⁷ / ₈ " , 2"
SJM010	10	Metric 33, 35, 36, 38, 41, 43, 44, 46, 48, 50

Robust 67 Piece Tool Kit

Packed in a rollup pouch

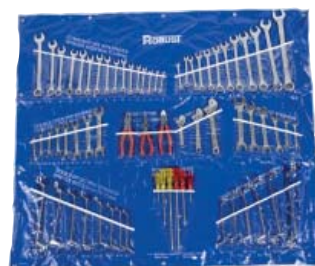

Beaver Code	Description
TKS067	67 Piece Tool Kit in rollup pouch

Roval Truck Wheel Wrenches



Beaver Code	Description
TWB025	1" x 17mm x 300mm
TWB027	27mm x 24mm x 300mm
TWB032	32mm x 17mm x 300mm
TWB035	35mm x 17mm x 300mm
TWB036	36mm x 27mm x 300mm
TWB038	38mm x 21mm x 395mm
TWB041	41mm x 21mm x 395mm
TWB041A	41mm x 19mm x 395mm
TWB114A	1 ¹ / ₄ " x 1 ¹ / ₁₆ " x 395mm
TWB118	1 ¹ / ₈ " x 1 ⁵ / ₁₆ " x 395mm
TWB516	1 ⁵ / ₁₆ " x 21mm x 395mm
TWB516A	1 ⁵ / ₁₆ " x 1 ¹ / ₄ " x 395mm
TWB516B	1 ⁵ / ₁₆ " x 1 ¹ / ₁₆ " x 395mm
BARTWW040	400mm Wrench Bar Only
BARTWW050	500mm Wrench Bar Only

NOT APPROVED FOR OVERHEAD LIFTING

Click Here To Close This PDF Document.